

BATTERY

Battery Trim Small 1L

Light Source: QR-CBC 51 GX5.3 - max 50W (LED Retrofit Compatible)

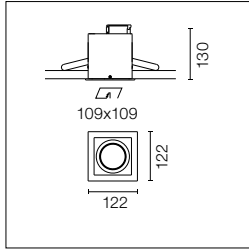
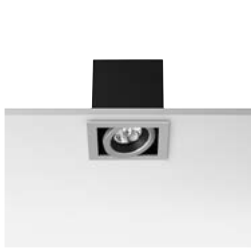

Recessed 12V halogen lamp luminaire. Remote transformer not included.

Luminaria empotrable para lámpara halógena de 12V. Transformador remoto no incluido.

Additional inner plastic (PPS) ring for lamp approaching & low glare effect.

Aro interior adicional de plástico (PPS) de alta resistencia.

Battery No Trim Small 1L

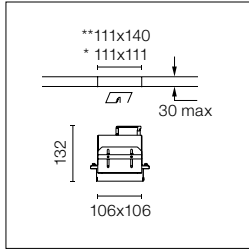

Pre-installation frame must be ordered separately.

Marco de pre-instalación. Se ha de pedir por separado.

- 04.6021.20
- 04.6021.08
- 04.6021.14

- 04.6021.20.NT
- 04.6021.08.NT
- 04.6021.14.NT

* Accessible ceiling: modular/open. | Techo accesible: modular/abierto.
 ** Inaccessible ceiling. | Techo no accesible.

Battery Trim Small 2L

Light Source: QR-CBC 51 GX5.3 - max 2x50W (LED Retrofit Compatible)

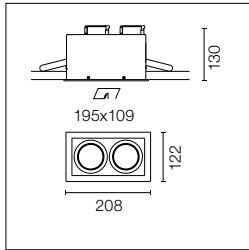

Recessed 12V halogen lamp luminaire. Remote transformer not included.

Luminaria empotrable para lámpara halógena de 12V. Transformador remoto no incluido.

Additional inner plastic (PPS) ring for lamp approaching & low glare effect.

Aro interior adicional de plástico (PPS) de alta resistencia.

Battery No Trim Small 2L

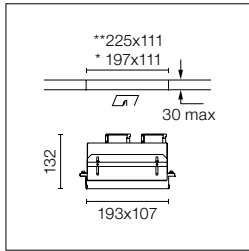

Pre-installation frame must be ordered separately.

Marco de pre-instalación. Se ha de pedir por separado.

- 04.6022.20
- 04.6022.08
- 04.6022.14

- 04.6022.20.NT
- 04.6022.08.NT
- 04.6022.14.NT

* Accessible ceiling: modular/open. | Techo accesible: modular/abierto.
 ** Inaccessible ceiling. | Techo no accesible.

BATTERY

Battery Trim Large 1L

Light Source: QR-111 G53 - max 100W

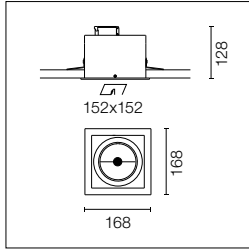

Recessed 12V halogen lamp luminaire. Remote transformer not included.

Luminaria empotrable para lámpara halógena de 12V. Transformador remoto no incluido.

Battery No Trim Large 1L

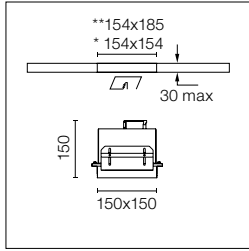

Pre-installation frame must be ordered separately.

Marco de pre-instalación. Se ha de pedir por separado.

- 04.6001.20
- 04.6001.08
- 04.6001.14

- 04.6001.20.NT
- 04.6001.08.NT
- 04.6001.14.NT

* Accessible ceiling: modular/open. | Techo accesible: modular/abierto.
 ** Inaccessible ceiling | Techo no accesible.

Battery Trim Large 2L

Light Source: QR-111 G53 - max 2x100W

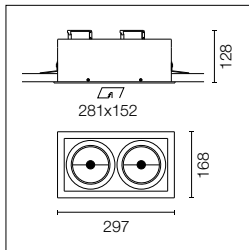

Recessed 12V halogen lamp luminaire. Remote transformer not included.

Luminaria empotrable para lámpara halógena de 12V. Transformador remoto no incluido.

Battery No Trim Large 2L

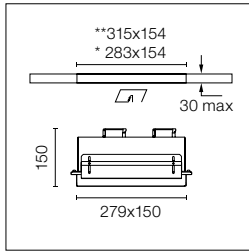

Pre-installation frame must be ordered separately.

Marco de pre-instalación. Se ha de pedir por separado.

- 04.6002.20
- 04.6002.08
- 04.6002.14

- 04.6002.20.NT
- 04.6002.08.NT
- 04.6002.14.NT

* Accessible ceiling: modular/open. | Techo accesible: modular/abierto.
 ** Inaccessible ceiling | Techo no accesible.

BATTERY

Accessories / Accesorios

Battery No Trim: LED Array

Pre-installation frame small single light.	Marco de pre-instalación de 1 luz pequeño.		08.8523.00
--	--	---	------------

Pre-installation frame small 2 lights.	Marco de pre-instalación de 2 luces pequeño.		08.8524.00
--	--	---	------------

Pre-installation frame small 3 lights.	Marco de pre-instalación de 3 luces pequeño.		08.8525.00
--	--	---	------------

Pre-installation frame small 4 lights.	Marco de pre-instalación de 4 luces pequeño.		08.8526.00
--	--	---	------------

Battery No Trim: QR-CBC 51

Pre-installation frame small single light.	Marco de pre-instalación de 1 luz pequeño.		08.8080.00
--	--	---	------------

Pre-installation frame small 2 lights.	Marco de pre-instalación de 2 luces pequeño.		08.8081.00
--	--	--	------------

Battery No Trim: QR-111

Pre-installation frame large single light.	Marco de pre-instalación de 1 luz grande.		08.8084.00
--	---	---	------------

Pre-installation frame large 2 lights.	Marco de pre-instalación de 2 luces grande.		08.8085.00
--	---	---	------------

BATTERY

Accessories / Accesorios

Battery Trim / No Trim: LED Array

Honeycomb Honeycomb		08.8495.14
Blue filter Filtro azul		08.8503.64.OD
Sky blue filter Filtro celeste		08.8503.65.OD
Amber filter Filtro ámbar		08.8503.66.OD
Red filter Filtro rojo		08.8503.67.OD
Hot light Hot light		08.8503.69
Cold light Cold light		08.8503.CL
Daylight Daylight		08.8503.DL
Neodimium Neodimium		08.8503.ND

Battery Trim / No Trim: QR-111

Elliptical lens Lente elíptica		<input type="checkbox"/> 08.8025.20 <input type="checkbox"/> 08.8025.08 <input type="checkbox"/> 08.8025.14
Screening cylinder Cilindro de apantallamiento		<input type="checkbox"/> 08.8030.20 <input type="checkbox"/> 08.8030.08 <input type="checkbox"/> 08.8030.14
Honeycomb Honeycomb		<input type="checkbox"/> 08.8029.20 <input type="checkbox"/> 08.8029.08 <input type="checkbox"/> 08.8029.14
Flood lens Lente flood		<input type="checkbox"/> 08.8180.20 <input type="checkbox"/> 08.8180.08 <input type="checkbox"/> 08.8180.14
Blue filter Filtro azul		<input type="checkbox"/> 08.8027.20.AO <input type="checkbox"/> 08.8027.08.AO <input type="checkbox"/> 08.8027.14.AO
Sky blue filter Filtro celeste		<input type="checkbox"/> 08.8027.20.AC <input type="checkbox"/> 08.8027.08.AC <input type="checkbox"/> 08.8027.14.AC
Amber filter Filtro ámbar		<input type="checkbox"/> 08.8027.20.AM <input type="checkbox"/> 08.8027.08.AM <input type="checkbox"/> 08.8027.14.AM
Red filter Filtro rojo		<input type="checkbox"/> 08.8027.20.RO <input type="checkbox"/> 08.8027.08.RO <input type="checkbox"/> 08.8027.14.RO
U.V. filter Filtro anti U.V.		<input type="checkbox"/> 08.8027.20.UV <input type="checkbox"/> 08.8027.08.UV <input type="checkbox"/> 08.8027.14.UV
I.R. filter Filtro anti I.R.		<input type="checkbox"/> 08.8027.20.IR <input type="checkbox"/> 08.8027.08.IR <input type="checkbox"/> 08.8027.14.IR
Hot light Hot light		<input type="checkbox"/> 08.8027.20.HL <input type="checkbox"/> 08.8027.08.HL <input type="checkbox"/> 08.8027.14.HL
Cold light Cold light		<input type="checkbox"/> 08.8027.20.CL <input type="checkbox"/> 08.8027.08.CL <input type="checkbox"/> 08.8027.14.CL
Daylight Daylight		<input type="checkbox"/> 08.8027.20.DL <input type="checkbox"/> 08.8027.08.DL <input type="checkbox"/> 08.8027.14.DL
Neodimium Neodimium		<input type="checkbox"/> 08.8027.20.ND <input type="checkbox"/> 08.8027.08.ND <input type="checkbox"/> 08.8027.14.ND